

KH-TV<sub>2</sub> 型  
(ダブルローズメカニカル式)

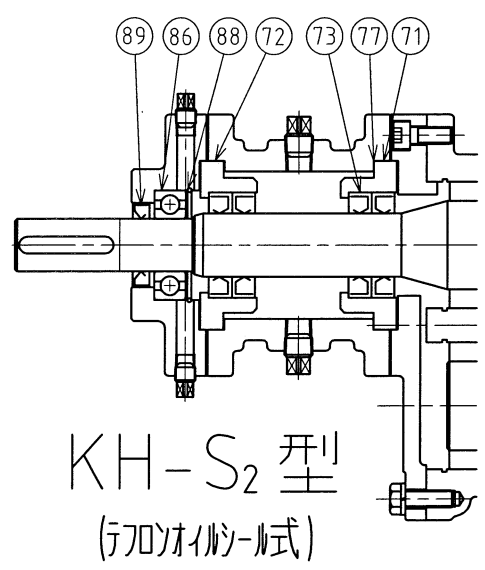

KH-S<sub>2</sub> 型  
(テフロンオイルシール式)

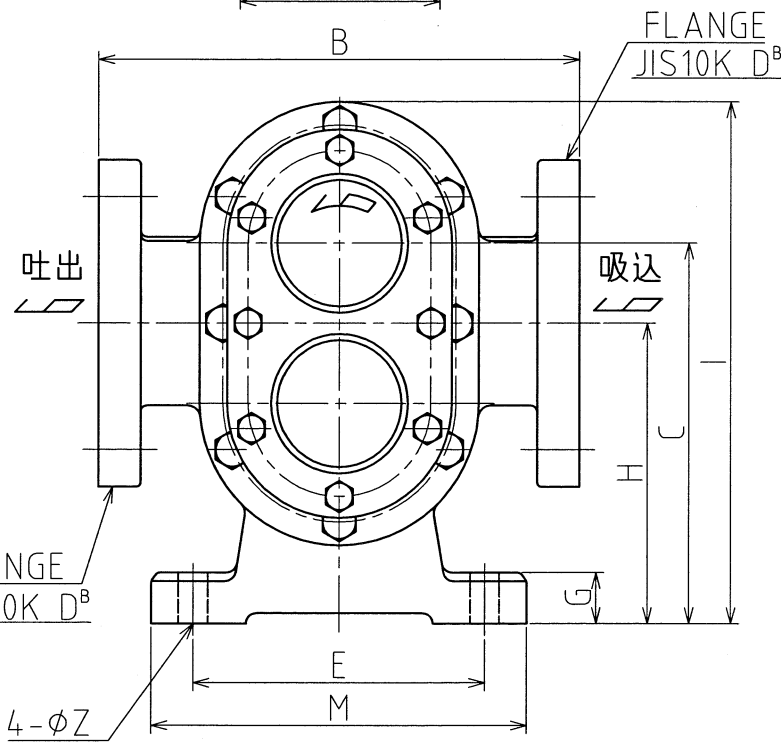

73	MECH. OIL SEAL	4	PTFE	78	MECH. SPRING	1	SUS304	10	DRIVEN SHAFT	1	SCM435H HARDENING
72	SEAL CASE B	1	SUS304	77	MECH. PACKING	4	PTFE	9	DRIVE SHAFT	1	SCM435H HARDENING
71	SEAL CASE A	1	SUS304	75	MECH. ROTATION RING	1	SUS304/METC016C	7	R.B. COVER	1	FC250
				74	MECH. SEAL RING	2	CARBON	5A	REAR COVER PACKING	1	PACKING PAPER
89	MECH. B. OIL SEAL	1	NBR	65	GLAND COVER	1	FC250	5	REAR COVER	1	FC250
88	MECH. B STOP RING	1	SWP	61	GLAND CASE	1	FC250	4	F.B. COVER	1	FC250
86	MECH. BALL BEARING	1	SUJ	60	KEY	1	S45C	2A	FRONT COVER PACKING	1	PACKING PAPER
83	MECH. LOCK NUT	1	S45C					2	FRONT COVER	1	FC250
80	MECH.SP. SUPPORTER	2	SUS304	18	SIDE PLATE METAL	4	BC6	1A	CASE PACKING	2	PACKING PAPER
79	MECH.SP. STOP RING	2	SUS304	14	GEAR	2	S45C	1	CASE	1	FC250
No.	NAME	QUANT.	MATERIAL	No.	NAME	QUANT.	MATERIAL	No.	NAME	QUANT.	MATERIAL