

Type: KH-Tv₂
(DOUBLE BELLOWS MECHANICAL SEAL)

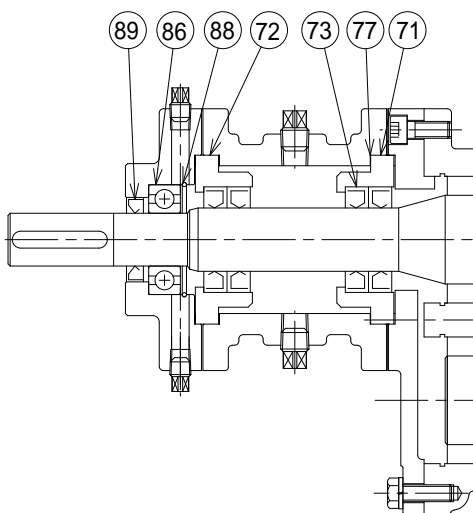

Type: KH-S₂
(OIL SEAL (PTFE))

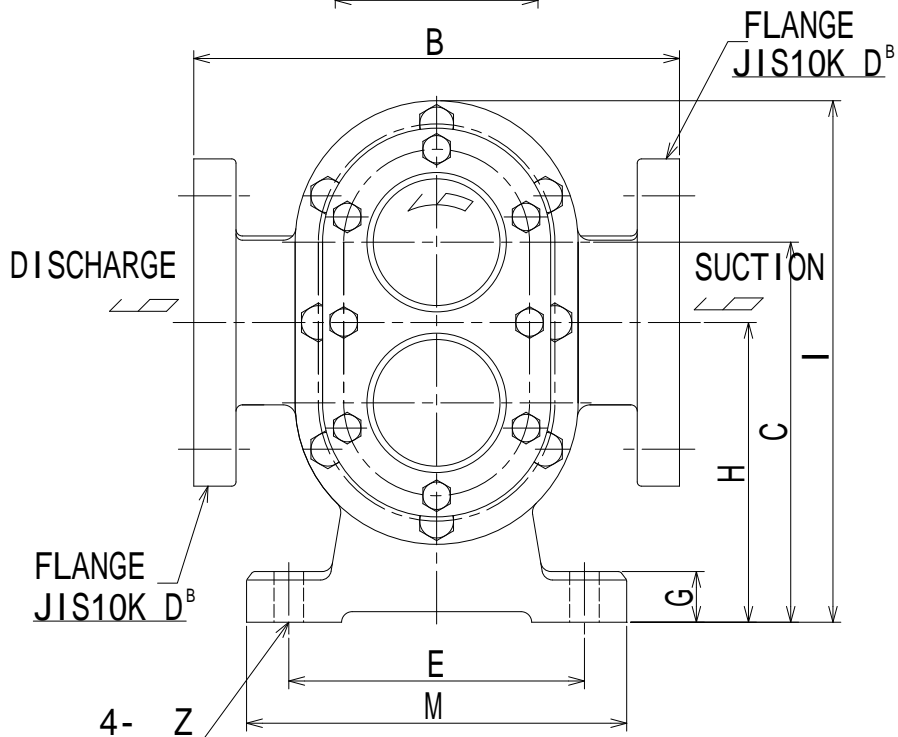

| | | | | | | | | | | | |
|-----|--------------------|--------|----------|-----|---------------------|--------|-----------------|-----|---------------------|--------|-------------------|
| 73 | MECH. OIL SEAL | 4 | PTFE | 78 | MECH. SPRING | 1 | SUS304 | 10 | DRIVEN SHAFT | 1 | SCM435H HARDENING |
| 72 | SEAL CASE B | 1 | SUS304 | 77 | MECH. PACKING | 4 | PTFE | 9 | DRIVE SHAFT | 1 | SCM435H HARDENING |
| 71 | SEAL CASE A | 1 | SUS304 | 75 | MECH. ROTATION RING | 1 | SUS304/METCO16C | 7 | R.B. COVER | 1 | FC250 |
| | | | | 74 | MECH. SEAL RING | 2 | CARBON | 5A | REAR COVER PACKING | 1 | PACKING PAPER |
| 89 | MECH. B. OIL SEAL | 1 | NBR | 65 | GLAND COVER | 1 | FC250 | 5 | REAR COVER | 1 | FC250 |
| 88 | MECH. B STOP RING | 1 | SWP | 61 | GLAND CASE | 1 | FC250 | 4 | F.B. COVER | 1 | FC250 |
| 86 | MECH. BALL BEARING | 1 | SUJ | 60 | KEY | 1 | S45C | 2A | FRONT COVER PACKING | 1 | PACKING PAPER |
| 83 | MECH. LOCK NUT | 1 | S45C | | | | | 2 | FRONT COVER | 1 | FC250 |
| 80 | MECH.SP. SUPPORTER | 2 | SUS304 | 18 | SIDE PLATE METAL | 4 | BC6 | 1A | CASE PACKING | 2 | PACKING PAPER |
| 79 | MECH.SP. STOP RING | 2 | SUS304 | 14 | GEAR | 2 | S45C | 1 | CASE | 1 | FC250 |
| No. | NAME | QUANT. | MATERIAL | No. | NAME | QUANT. | MATERIAL | No. | NAME | QUANT. | MATERIAL |